



LECCY & GENESIS

A8 Manual

(Smart Doorlock)

Installation guide of double latches mortise

1. Accessory

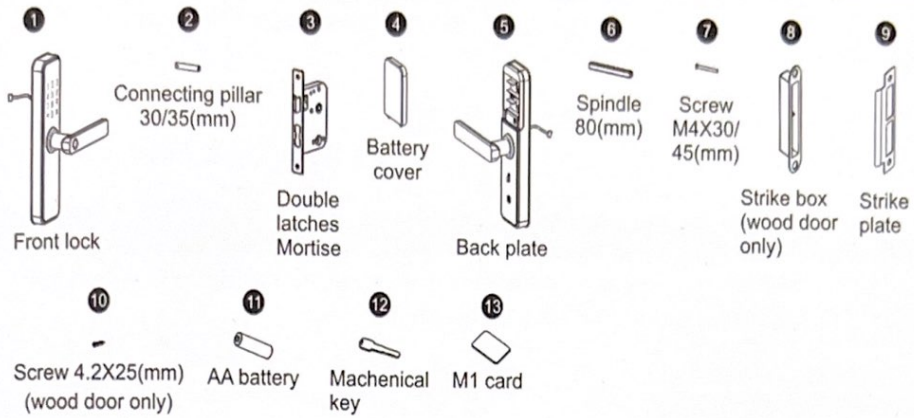

2. Door opening direction

① Right handle opening

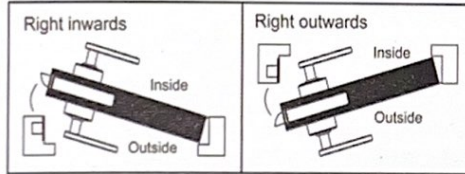

② Left handle opening

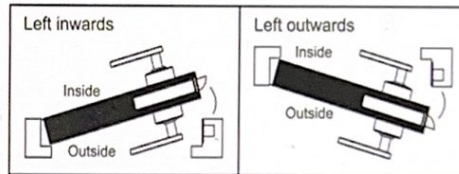

3. Shift the left and right

According to your needs to adjust the left and right by a screw driver to release screw, then turn the handle 180 degree, then fix the screw.

Note: Do not unscrew the screw in the handle hole, if there is broken when you do that, you will not have any warranty.

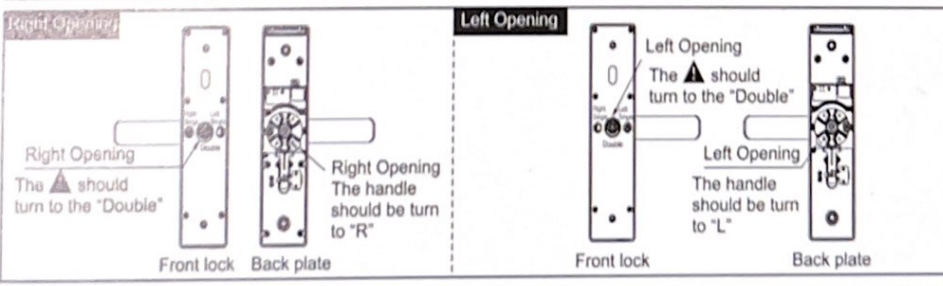
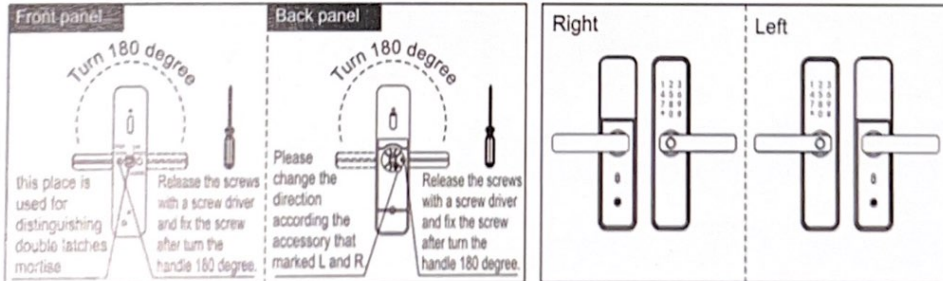

4. Adjust the mortise direction

According to your need to adjust the mortise direction.

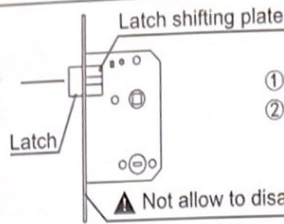

- ① Pull the Latch shifting plate to another side
- ② Push the latch into the mortise and turn 180 degree

⚠ Not allow to disassemble the face plate

5. Accessories for sorts of door thickness

Available door thickness 35mm-55mm. If the door is over this range, please contact us for more information. Please select the correct accessories according to your door thickness.

Code and name	Specifications(mm)	door thickness ranges & QTY	
		35 ≤ M ≤ 40(mm)	41 ≤ M ≤ 55(mm)
⑥ Spindle 80(mm)	80	1	1
⑩ Screw 4.2X25(mm) (wood door only)	25 I 4.2	4	4
⑩ Screw M4X30/ 45(mm)	30 M4	1	
	45 M4	1	2
② Connecting pillar 30/35(mm)	30	1	
	35	1	2

6. Caution before installation

- ① Do not be a strong force when installation, avoid to damaging the lock.
- ② Use correct installation tools.
- ③ Wear glass to protect your eyes when drilling holes.
- ④ Drilling the door holes on both side of the door avoiding to damaging the door plate.

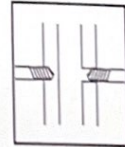
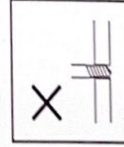
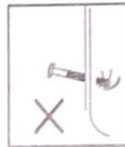

7. Installation

Installation steps:

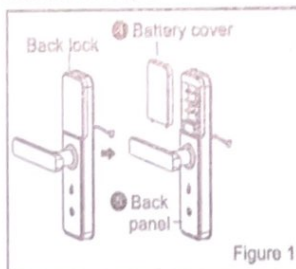

Figure 1

- (1) As Figure 1:
① Divide the Back Lock into Battery cover and Back panel.

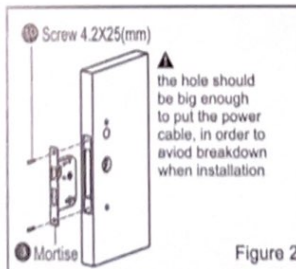

Figure 2

- (2) As Figure 2:
① Make the mortise cable get through the door plate, fix the mortise with 2 screws.

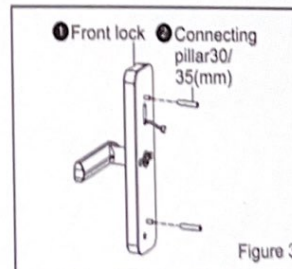

Figure 3

- (3) As Figure 3:
① Fix the two connecting pillars on the front panel

7. Installation

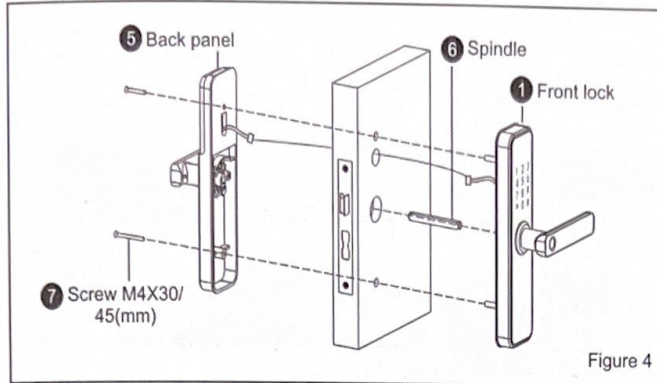

Figure 4

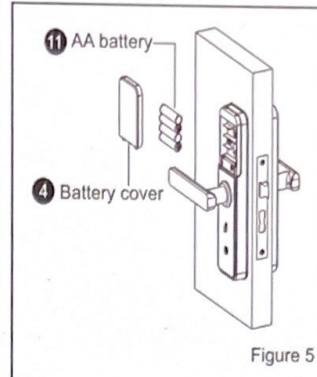

Figure 5

(4) As Figure 4:

- 1 Put the spindle on the mortise.
- 2 Make the front panel cable across to the door plate and connect to the back panel.
- 3 fix the front panel and back panel with two screws.

(5) As Figure 5:

- 1 Put the Batteries correctly and fix the Battery cover.

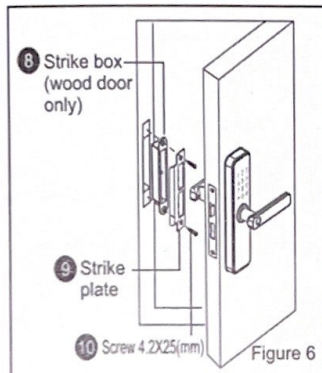

Figure 6

(6) As Figure 6:

- 1 Install the strike box and strike plate on the door frame with 2 screws.
(Note: this no strike box for steel door frame)
- 2 Test the lock if it works correctly.

8. Check points after installation

- 1 The face plate is horizontal with the door.
- 2 The Latch bolt, Dead bolt and Security Bolt must works smoothly and flexibly.
- 3 The Front lock is vertical and stable.

Intelligent lock(five in one) operation manual

1-STORAGE CAPACITY

ITEM	CAPACITY	AUTHORITY
Administrator	1	Management equipment
Fingerprint	300	Opening
Password		Opening
IC Card		Opening

2-INTRODUCE

2.1- INITIAL INFORMATION

- Key[*]: clear key/back key.
- Key[#]: confirmation key or menu function key.
- To open the door with a **password**, have to touch the keypad or fingerprint head to activate the button light (fingerprint headlight is a breathing effect), and then press the [#] key to confirm after entering the password.
- To open the door with **cards**,there is no need to activate the button light, just swipe the card directly.
- To open the door with **fingerprints**,there is no need to activate the button light.Enter fingerprint directly.
- If the verification is successful, the lock is unlocked by voice broadcast, the green light is on, and it flashes every 1 second. It will be automatically locked after a few seconds.
- If the verification fails, the button light flashes 3 times, the fingerprint head lights up in red, and the voice prompts the operation to fail.

2.2-. ORIGINAL STATE

- The factory administrator initial password is "123456", under the initial state any fingerprint, IC card or password can open the lock.
(for safety, the default password must be changed after normal use!)
- Any fingerprint, IC card or password which are not input can't open the lock after inputting the administrator information.
- After entering the administrator menu:
 - [1] Add unlocking information
 - [2] Delete unlocking information
 - [3] Change management code
 - [4] Volume setting
 - [5] Language setting
 - [9] Network setting

3.Access door lock function management

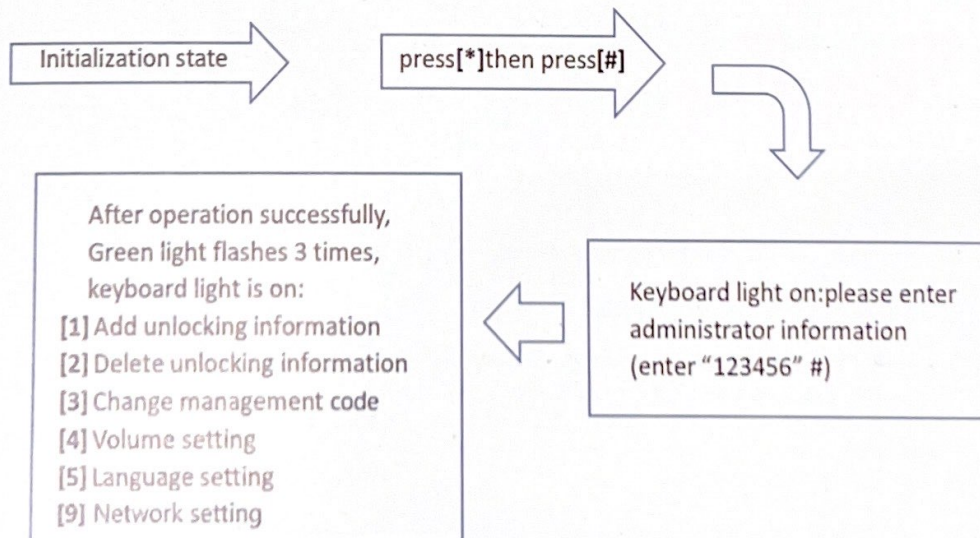

3.1- ADD USERS INFORMATION

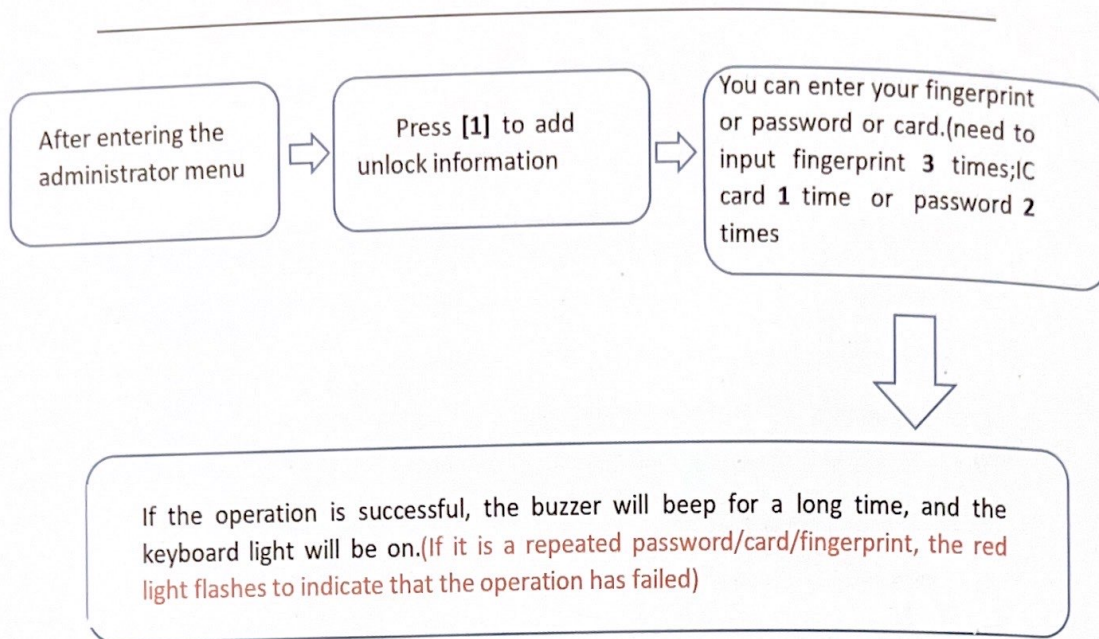

3.2- DELETE USERS

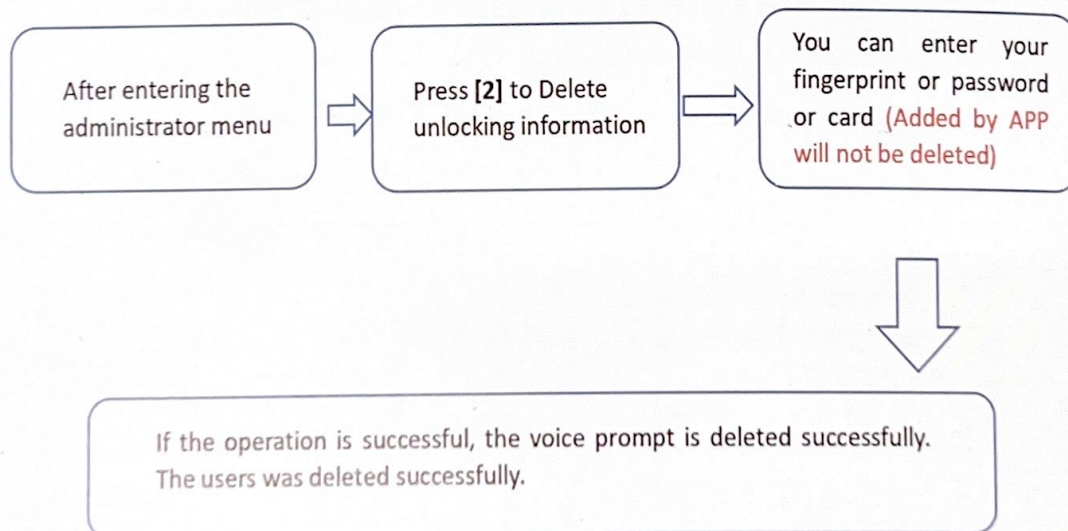

*SPECIAL FUNCTION CODE:

Key [21#] Delete all passwords

Key [22#] Delete all cards

Key **[23#]** Delete all fingerprints

Key **[24#]** Delete all passwords/cards/fingerprints

3.3- CHANGE MANAGEMENT INFORMATION

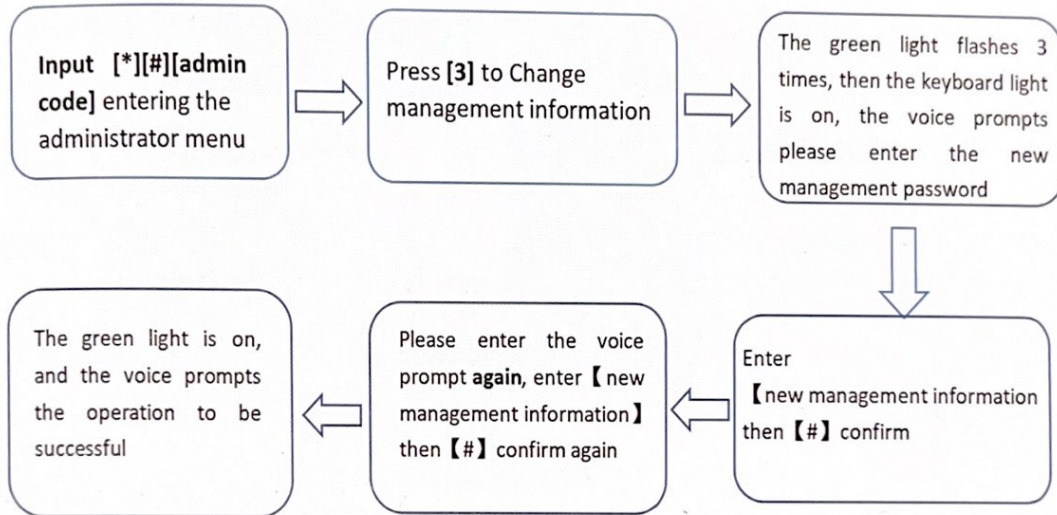

3.4- VOICE SETTING

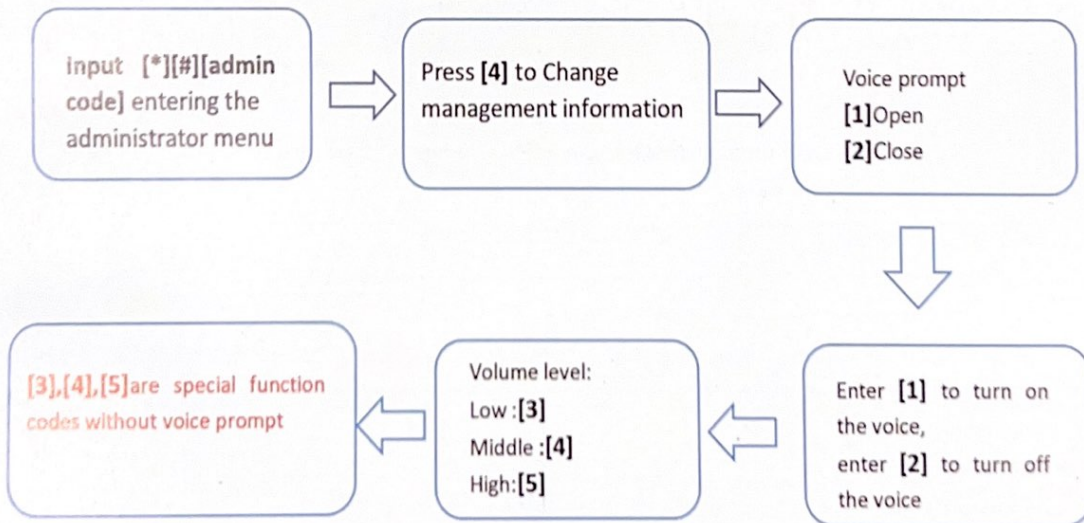

- The volume will not be muted in the administrator menu mode. The volume is set to high by default. It will be executed after exiting the administrator after the voice setting is completed.
- If the voice is turned off, the flashing keyboard light will be used as a reminder when you press the number keys.
- Press **[*][#]** Even if the voice is turned off, there will be voice prompts to enter the menu

3.5- LANGUAGE SELECTION

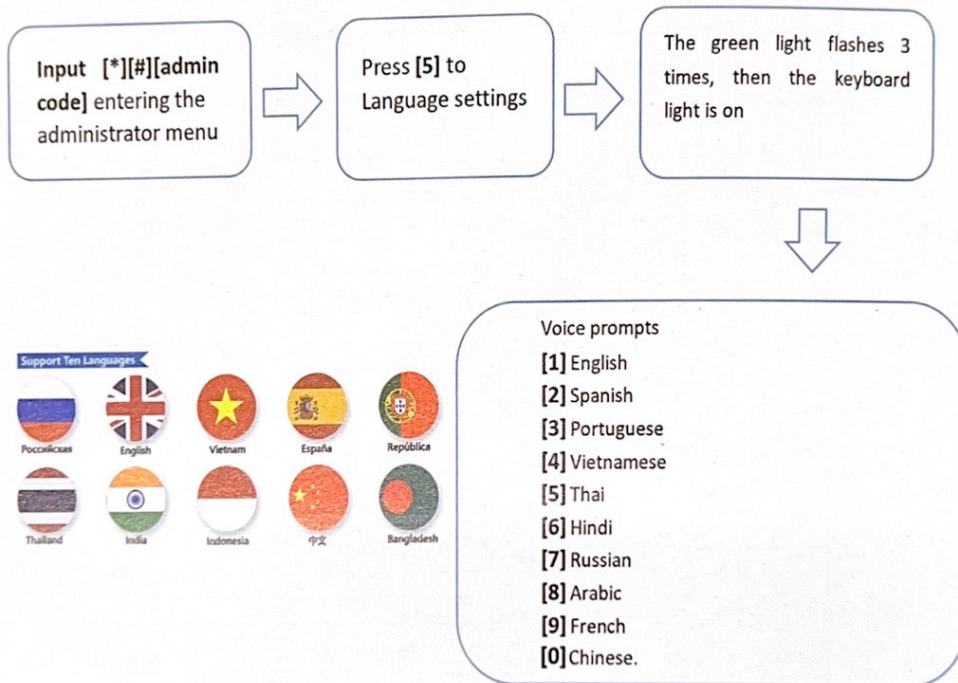

4. APP Configuration (Tuya Smart) - optional

- 1) Search "Tuya Smart" in App Store or an App market, download and install it.
- 2) Register with your cellphone number and log in.
- 3) Click "Security & Sensor", find "Lock(Wi-Fi)", click and add a device following instructions before use.
- 4) Remote unlocking: wake up the screen and press "9"+"#". There will be a voice prompt: requesting remote unlocking.

Add one network

- 1) Press "*"+"#" to authenticate administrator identity and then press "9" to access Network settings.
- 2) Voice prompt in network configuration mode: press "02" for hotspot connection and "01" for intelligent connection.



5.SAFE MODE (Optional)

- Toggle the button on the back of the lock to turn on the safe mode. In this state, the door lock can only be opened by the **management password**. This mode prohibits the user from unlocking the lock by password/fingerprint/card, and disables all Bluetooth functions. (Some models do not support this function)

Electronic anti-lock function

Easier to say is permission management
For example: when you are an administrator, when your parents are ordinary users, Indoor door lock anti-lock, Only administrator purview can be unlocked outdoors. Ordinary users cannot unlock.



6.SET THE NORMALLY OPEN

- In the non-safe mode, input the number key [5]and [#] before each time unlock,and then input the password/fingerprint/card to open the door. This time the door will not be locked.

7.Technical Parameters

Technical Parameters			
	Items	Parameters	Memo
1	Static current	≅ 50uA	
2	Dynamic current	≅ 180mA	
3	Administrators number	1	
4	Fingerprint number	100	
5	Fingerprint + password + card capacity	300	
6	Fingerprint Sensor	Semiconductor	
7	Fingerprint contrast time	≅ 0.6Second	
8	Fingerprint identification Angle	360°	
9	False Rejection Rate	≅ 0.1%	
10	False Recognition Rate	≅ 0.0001%	
11	Reaction time	≅ 0.1 Second	
12	Power type	6V	
13	Emergency power	5VDC	
14	Working temperature	-25℃~60℃	
15	Working Relative Humidity	20%~90%RH	
16	Human voice	Yes	
17	Keyboard	Touch standard 12-bit keyboard	
18	Password Length	6-12 digits	
19	Phantom password	32 digits	
20	Low voltage alarm	4.6±0.2V	
21	Unlock time	≅ 1Second	

Smart lock manual



Main function modules

1、APP registration and login

- APP registration: if you do not have an APP account, you can choose to register or log in by SMS verification code.
- Click "create a new account" to enter the account registration page. According to the prompt to obtain SMS verification code, set the password.
- If you have an existing account, click "login with an existing account" to log in to the APP. Password, verification code, and social account login are supported.

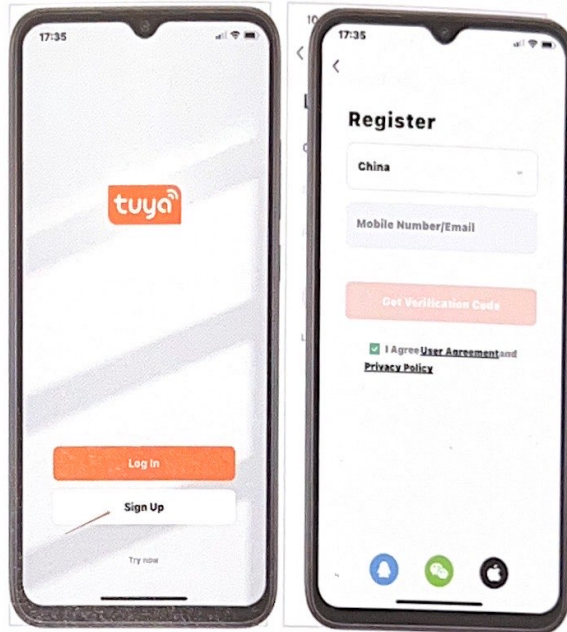

2、Create Homes

- Create your home after registering and logging in successfully.
- Each account can create and add multiple homes, and devices can be grouped by room in the home.
- Weather and other functions depend on the geographical location of the family, which is recommended to set in advance.

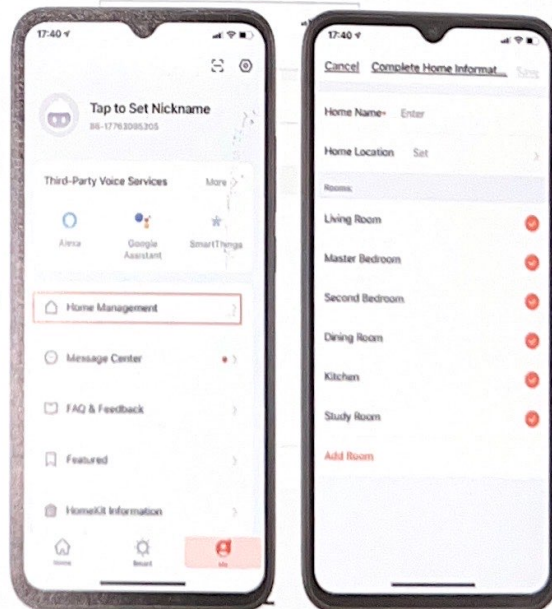

Main function modules

3. Add WiFi lock

- On the Tab of "my home", click "+" in the upper right corner to enter the interface in figure 1, select the WiFi door lock in security sensor part and enter the page in figure 2.
- When the device enters the connected mode, continue to operate according to the instructions and APP tips.

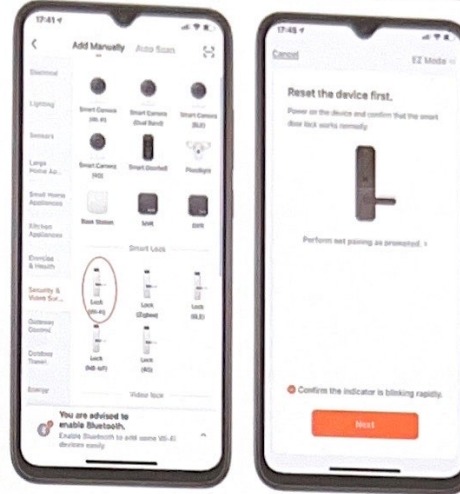

4. Home Page

- Home page includes remote unlock, alarm message, member management, record, temporary password and other functions.
- Remote Unlock: initiate a request from the door lock, and the app can respond to allow / refusal door opening

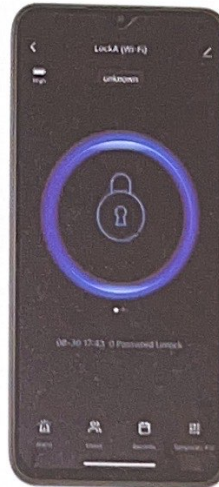

5. Dynamic password

- Click to get the dynamic password Meanwhile copy the password text for you

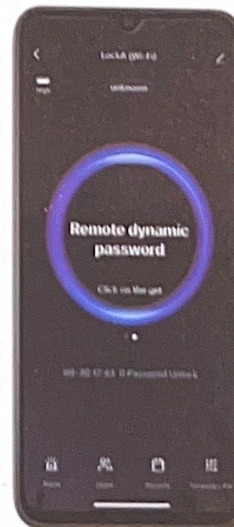

Main function modules

6. Message center

- Message center contains alarm information, doorbell call information and hijacking alarm information, which can be inquired.

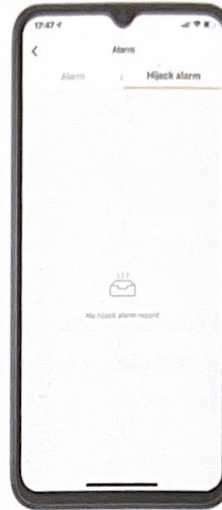

7. User Management

- User can be added, deleted or changed in member management.
Only the administrator user of app is allowed to do that.

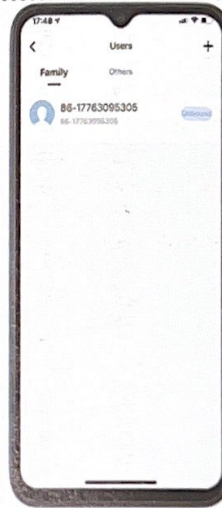

8. Record Log

- 24/7 Record Log, arranged in reverse chronological order. The unlocked ID with the associated user name will directly display the user name, while the unlocked ID without the associated name will display the specific unlock ID

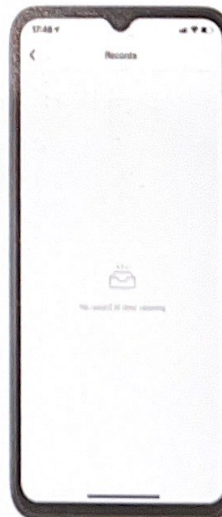

Main function modules

9. Temporary password

- Temporary password can be created and deleted through app. After each create or delete is completed on the app, the lock hardware is required to synchronize with the server.
- At the time of creation, you can choose whether to send SMS or not. Worldwide SMS is supported.

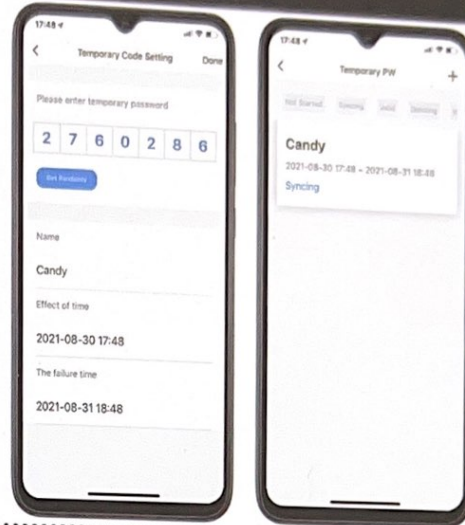

10. Hijacking alarm

- When the anti-hijacking mark in the left picture is opened, if the unlock action of the unlock ID occurs, the record will report and the app will trigger the anti-hijacking alarm

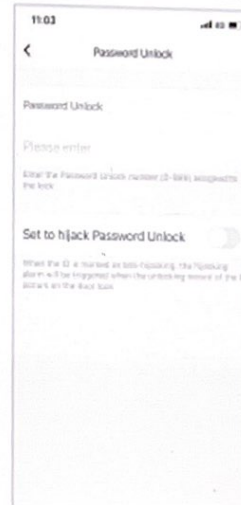

11. Factory Data Reset

- Click the icon in the upper right corner of the main interface. Find the Factory Data Reset and click.
- The Factory Data Reset can also be operated on the lock. Please refer to the instruction manual for details.

