

# Smart lock manual

# Installation guide of double latches mortise

## 1. Accessory

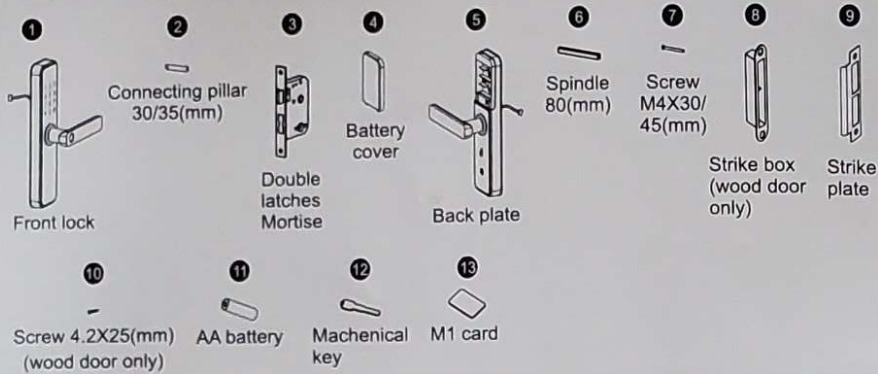

## 2. Door opening direction

### 1 Right handle opening

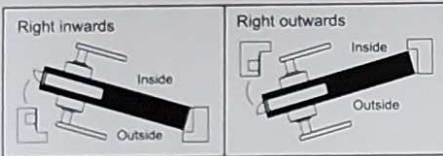

### 2 Left handle opening

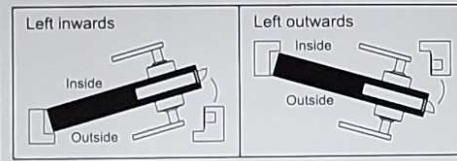

## 3. Shift the left and right

According to your needs to adjust the left and right by a screw driver to release screw, then turn the handle 180 degree, then fix the screw.  
Note: Do not unscrew the screw in the handle hole, if there is broken when you do that, you will not have any warranty.

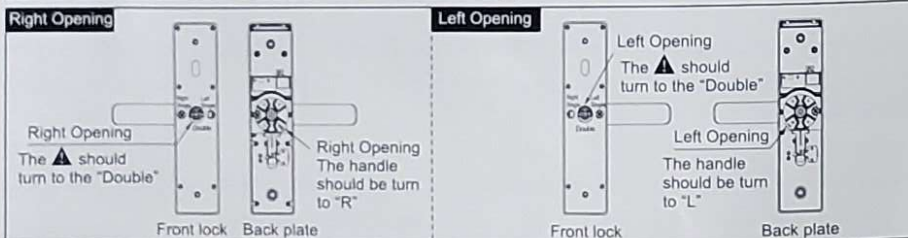
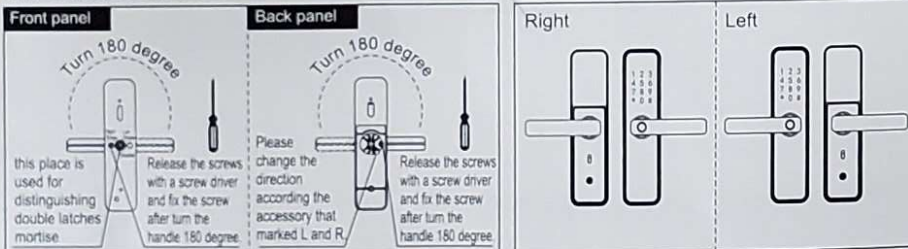

## 4. Adjust the mortise direction

According to the your need to adjust the mortise direction.

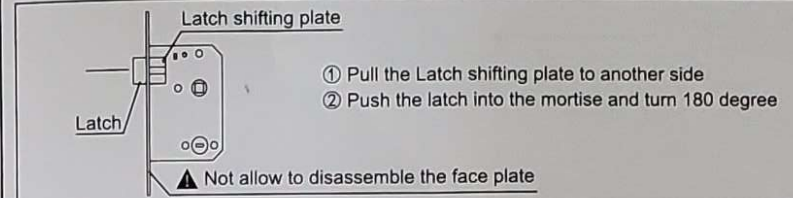

## 5. Accessories for sorts of door thickness

Available door thickness 35mm-55mm. If the door is over this range, please contact us for more information. Please select the correct accessories according to your door thickness.

Code and name	Specifications(mm)	door thickness ranges & QTY	
		35 ≤ M ≤ 40(mm)	41 ≤ M ≤ 55(mm)
6 Spindle 80(mm)	80	1	1
10 Screw 4.2X25(mm) (wood door only)	25 4.2	4	4
10 Screw M4X30/45(mm)	30 M4	1	
	45 M4	1	2
2 Connecting pillar 30/35(mm)	30	1	
	35	1	2

## 6. Caution before installation

- Do not be a strong force when installation, avoid to damaging the lock.
- Use correct installation tools.
- Wear glass to protect your eyes when drilling holes.
- Drilling the door holes on both side of the door avoiding to damaging door plate.



## 7. Installation

Installation steps:



- As Figure 1:  
1 Divide the Back Lock into Battery cover and Back panel.
- As Figure 2:  
1 Make the mortise cable get through the door plate, fix the mortise with 2 screws.
- As Figure 3:  
1 Fix the two connecting pillars on front panel

# Intelligent lock(five in one) operation manual

## 1. Function and Operation

### 1.1 Description of terms and functional keys

- 1) Administrator information: refer to the Administrator's fingerprint, password or IC card.  
Unlock information: refer to the input fingerprint, password, Remote control or IC card information (including Administrator and ordinary users).
- 2) Key"\*": clear key/back key. Enter the password or point by clearing the previous input. Press the clear key three times in succession, empty all input.
- 3) Key"#": confirmation key or menu function key.

## 2. Original state

- 1) The factory administrator or initial password is 123456, under the original state any fingerprint, IC card or password can open the lock.
- 2) Any fingerprint, IC card, or password which are not registered can't open the lock after inputting the administrator information.

## 3. Lock function management (step one)

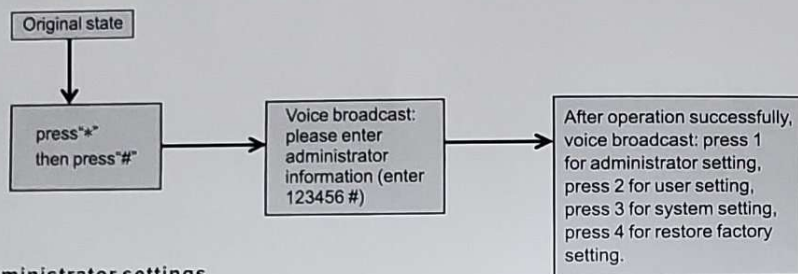

## 4. Administrator settings

### 1) Add administrator (step 2)

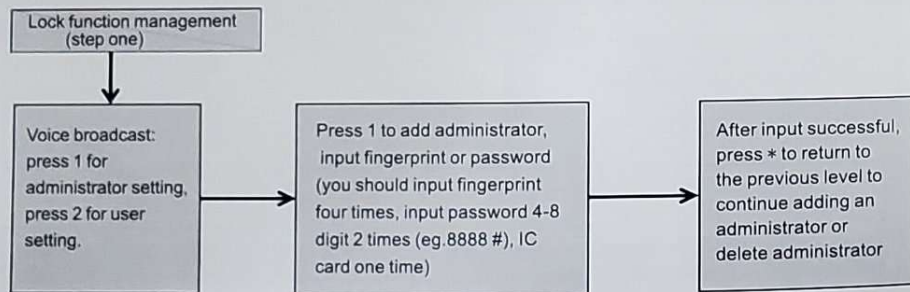

### 2) Delete administrator information

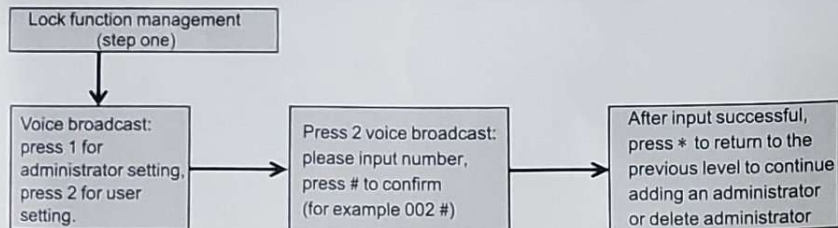

## 5. Common user setting

### 1) Add administrator information

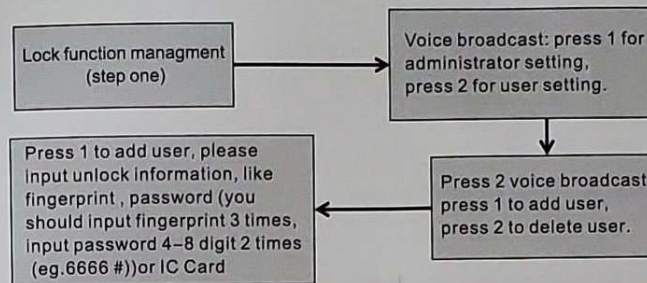

### 2) Delete user information

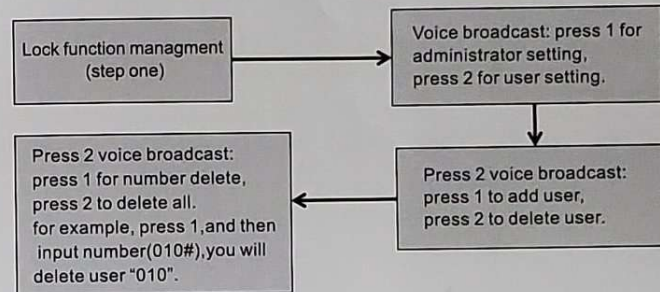

## 6. system setting

### 1) Voice setting

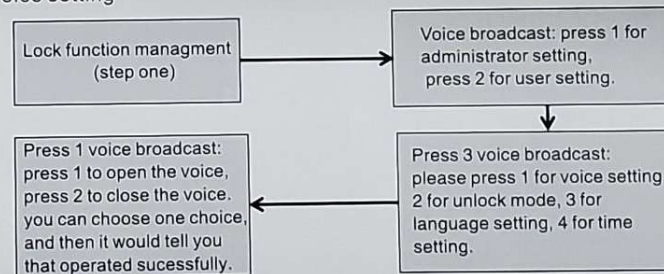

### 2) Unlock mode setting

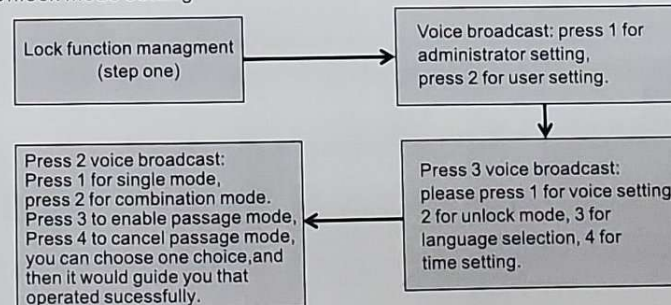

### 3) Language settings

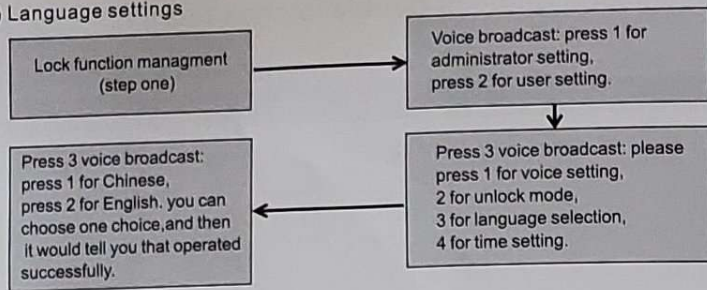

### 4) Time setting

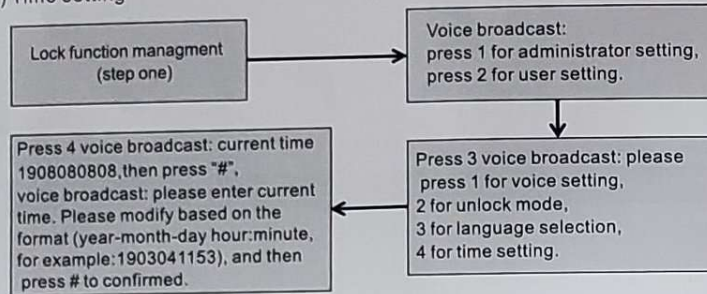

### 7. Restore factory settings

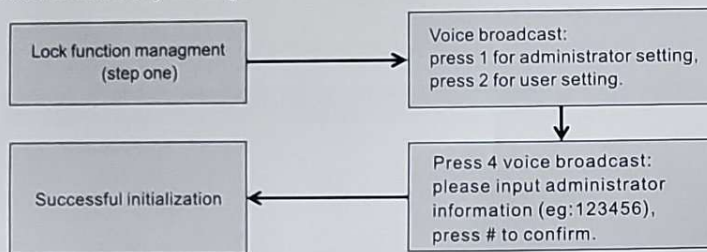

### 8. APP Configuration (Tuya Smart) - optional

- 1) Search "Tuya Smart" in App Store or an App market, download and install it.
- 2) Register with your cellphone number and log in.
- 3) Click "Security & Sensor", find "Lock(Wi-Fi)", click and add a device following instructions before use.
- 4) Remote unlocking: wake up the screen and press "9"+"#". There will be a voice prompt: requesting remote unlocking.

#### Add one network

- 1) Press "\*"+"#" to authenticate administrator identity and then press "1" to access administrator settings. Then there will be a voice prompt of pressing "3" for network configuration.



- 2) Voice prompt in network configuration mode: press "1" for hotspot connection and "2" for intelligent connection.

3) When the network is successfully added, the 1<sup>st</sup>, 2<sup>nd</sup>, 3<sup>rd</sup> and 4<sup>th</sup> lights on the keyboard will be on in order with a voice prompt of "operation completed".

4) In the event of network addition failure, the 1<sup>st</sup>, 2<sup>nd</sup>, 3<sup>rd</sup> and 4<sup>th</sup> lights on the keyboard will not be on and there will be a voice prompt of "operation failed" upon timeout.

Notice:

Please add administrator before setting.

### 9. Other notes

- 1) Input the wrong password more than 5 times in a row, the keyboard locked for 30 seconds, it does not respond to any operations in 30 seconds.
- 2) Password peeping prevention function: input password as follows when opening the door with password: XXX password XXX; you can add some extraneous codes before and after the password, and then press # to confirm. The password must be included in the input contents.
- 3) If there is no operation more than 10 seconds, system will automatically exit.
- 4) After the voltage is lower than 4.6v, the lock will automatically alarm every time when it is opened. After the alarm, the lock can be opened for about 200 times.
- 5) Remove the battery cover, press the "Set" key for 6 seconds, the lock was restored to factory mode;
- 6) In factory mode, input "333666999#" can change the language quickly;
- 7) When unlocking, input "5#" to enter passage mode (One time effective);
- 8) When unlocking, input "\*" to broadcast the user number;
- 9) When Electronic dead lock was opened, Only the administrator can open the lock

### 10. Technical Parameters

Technical Parameters			
	Items	Parameters	Memo
1	Static current	≤ 50uA	
2	Dynamic current	≤ 180mA	
3	Administrators number	9	
4	Fingerprint number	100	
5	Fingerprint + password + card capacity	300	
6	Fingerprint Sensor	Semiconductor	
7	Fingerprint contrast time	≤ 0.6Second	
8	Fingerprint identification Angle	360°	
9	False Rejection Rate	≤ 0.1%	
10	False Recognition Rate	≤ 0.0001%	
11	Reaction time	≤ 0.1 Second	
12	Power type	6V	
13	Emergency power	5VDC	
14	Working temperature	-25°C~60°C	
15	Working Relative Humidity	20%~90%RH	
16	Human voice	Yes	
17	Keyboard	Touch standard 12-bit keyboard	
18	Password Length	4-8 digits	
19	Phantom password	32 digits	
20	Low voltage alarm	4.6 ± 0.2V	
21	Unlock time	≤ 1Second	

## 7. Installation

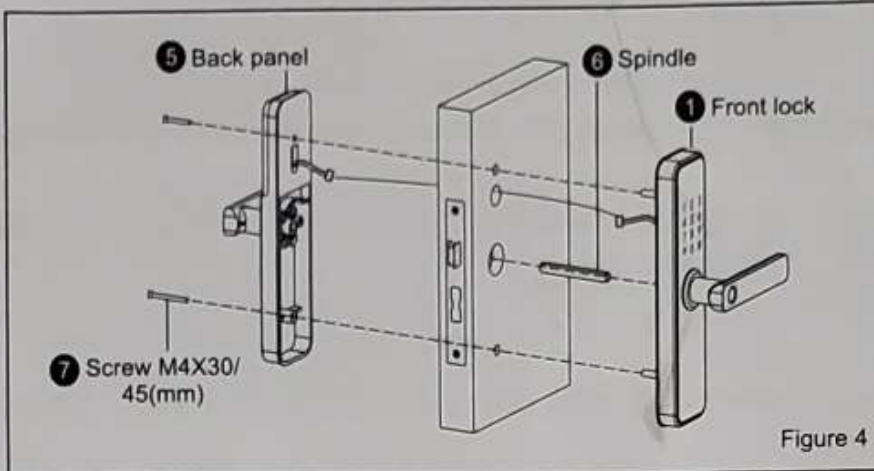

(4) As Figure 4:

- ① Put the spindle on the mortise.
- ② Make the front panel cable across to the door plate and connect to the back panel.
- ③ fix the front panel and back panel with two screws.

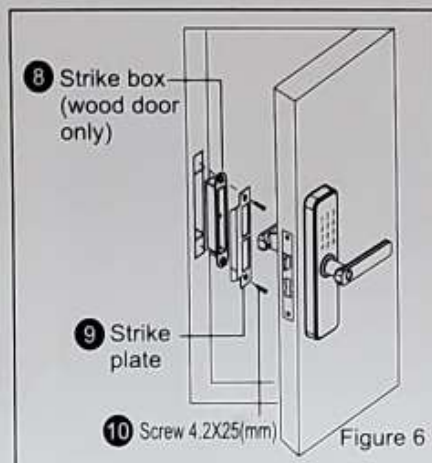

(6) As Figure 6:

- ① Install the strike box and strike plate on the door frame with 2 screws.  
(Note: this no strike box for steel door frame)
- ② Test the lock if it works correctly.

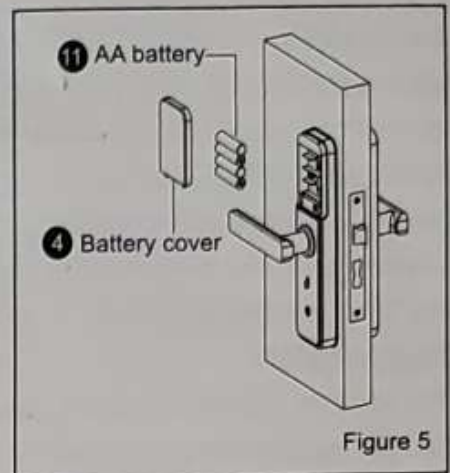

(5) As Figure 5:

- ① Put the Batteries correctly and fix the Battery cover.

## 8. Check points after installation

- ① The face plate is horizontal with the door.
- ② The Latch bolt, Dead bolt and Security Bolt must works smoothly and flexibly.
- ③ The Front lock is vertical and stable.